

Version Modification Record			
Rev.	Modify Content	Date	Modifier

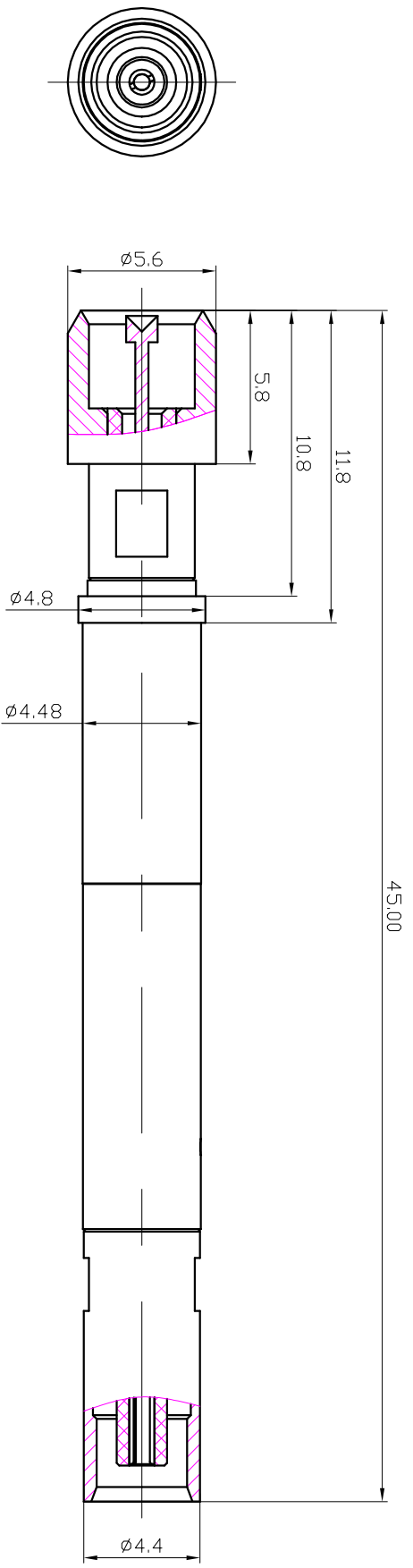
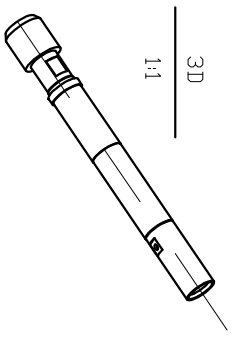

- ELECTRICAL PERFORMANCES**
1. IMPEDANCE: 50 OHM;
  2. WORKING FREQUENCY: DC-8GHZ;
  3. VSWR : <1.3 (DC-6GHZ);
  4. DIELECTRIC WITHSTANDING VOLTAGE : 500VDC (CURRENT=1A);

- MECHANICAL PERFORMANCES**
- 1.FULL TRAVEL:3.7MM @INNER ,AND 5.0MM @DUTER;
  - 2.RECOMMENDED TRAVEL:2.0MM @INNER, AND 3.7MM @DUTER;
  - 3.SPRING FORCE: 100G@ INNER, AND 400G @DUTER;
  - 4.TEST CONNECTOR : FAKRA MALE(6GHZ);

- MATERIAL AND PLATING**
1. BODY FOR THE PROBE : CU ALLOY AND GOLD PLATING;
  2. CONTACT FOR THE PROBE : BECU AND GOLD PLATING;
- OPERATING TEMPERATURE RANGE:**  
-55℃-+85℃

- APPLICATION AREA**
- 1.AUTOMOBILE TEST AREA;
  - 2.COMMUNICATION TEST AREA.

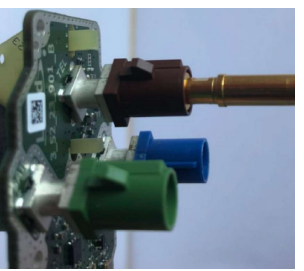

DIAGRAM OF TEST

MCMX FEMALE

上海里库电子科技有限公司 DEPARTMENT: RF COXIAL TEST PROBE, FOR FAKRA MALE CONNECTORS, 6GHZ		P/N	RC860PE-6G
		NAME	RF PROBE
REV.	A	DESIGN	
Scale	1:1	DATE	2018-05-04
Unit	MM		
QTY			

DECIMALS:

0.5 ≤ X ≤ 6	±0.05
6 < X ≤ 30	±0.1
30 < X ≤ 120	±0.15
120 < X ≤ 400	±0.2

ANGLES:

~10	±3°
>10~50	±2°